

JUMP TO  
SPECS 



# LODGE

PODS & BOOTHS



### **LODGE MEETING PODS**

Office pods are a highly practical fix, giving employees private, acoustically controlled spaces to focus, meet, or recharge - without costly construction.

Lodge meeting pods are designed for focus, comfort and performance, these sleek units create a serene environment that enhances productivity and well-being.

Available in four versatile models, there's a perfect fit for every user.





# LODGE MEETING PODS

## OVERVIEW

- A selection of acoustic pods to suit the needs of any workspace
- Air purifying system with HEPA filter
- Motion sensor LED lighting and air ventilation system
- Charging ports with AC outlet, type A and C port
- Sound insulating acoustic material

- Auto-close tempered glass door
- Knockout hole for sprinkler
- Personalised settings with a touch control panel
- Occupancy indicator light
- Tested to ISO 23351-1 Standard High Acoustic Rating - DS,A - Class B & UL Greenguard Certified
- 6 - 8 weeks lead time

**Delivery & Installation:** Hawk strongly recommends that delivery and installation of the Lodge pods be carried out by our installation team to avoid double handling. Hawk will not be responsible for any damage arising from the client's use of their own installation resources. Where self-assembly is selected, full responsibility transfers to the client upon delivery. Weekday / office hours installation (ground floor or lift access): £2,000 (subject to site survey) Multiple units, weekday out-of-office hours, weekend installation, or installations above or below ground floor: POA

## SHAPES & STYLES



Lodge Solo      Lodge Focus      Lodge Connect      Lodge Retreat

## QUALITY

This range has been designed and manufactured to our high standards of quality and is guaranteed for 5 years.

## CONFORMITY

We endeavour to only source products from FSC® certified suppliers. FSC® certified timber products are available on request. (License Holder FSC®C199861).

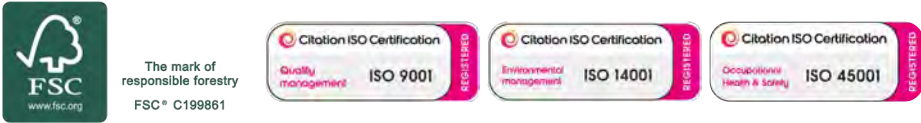

LODGE SOLO



**Width:** 1000mm  
**Depth:** 1000mm  
**Height:** 2280mm  
**Net Weight:** 265.55kg  
**Power Consumption:** 0.18A  
**Airflow:** 152m³/h

Designed for a single occupant  
Laminated desktop included  
Unit supplied on heavy duty castors

LODGE CONNECT



**Width:** 2200mm  
**Depth:** 1250mm  
**Height:** 2280mm  
**Net Weight:** 497.65kg  
**Power Consumption:** 0.33A  
**Airflow:** 304m³/h

Suitable for up to 4 occupants  
Includes upholstered sofas with backrests  
Laminated desktop included  
Unit supplied on heavy duty castors

LODGE FOCUS



**Width:** 1400mm  
**Depth:** 1250mm  
**Height:** 2280mm  
**Net Weight:** 363.7kg  
**Power Consumption:** 0.18A  
**Airflow:** 152m³/h

Suitable for up to two occupants  
Includes upholstered sofa with backrest  
Extendable desktop with storage included  
Unit supplied on heavy duty castors

LODGE RETREAT



**Width:** 2400mm  
**Depth:** 2400mm  
**Height:** 2280mm  
**Net Weight:** 833kg  
**Power Consumption:** 0.47A  
**Airflow:** 304m³/h

Suitable for up to 6 occupants  
Can be supplied with or without upholstered L-shape sofa

LODGE SOLO

Dimensions (mm)	1000 x 1000 x 2280 (external) 830 x 910 x 2030 (internal)
Weight (kg)	Net weight: 266 Packing weight: 400
Acoustic Properties	High acoustic rating (28.9 dB noise reduction) ISO 23351-1 Speech Level Reduction DS,A
Material	1.2mm electro galvanized steel
External Finishing	Epoxy powder coating (Space Grey or Smoke White colour options)
Internal Finishing	Polyester fibre acoustic felt sheet in dark grey Fibre nylon carpet in black
Glass Door	Black aluminium door frame with laminated tempered glass and door closer
Rear Glass	Laminated glass
Table (mm)	Melamine laminated wood desktop with chamfered edging (820W x 320D x 25H)
Power	1 x UK power socket 65W USB A+C charger 1 x CAT 6 LAN outlet Power consumption 0.18A
Ventilation	HEPA filtered air ventilation (99 air changes per hour) 2 x ventilation fans
Motion Sensor	Motion sensor control, 12V DC - sensor duration adjustable
Lighting	4000k LED light system with dimmable control (1 x 11W) External occupancy light (green/red) to indicate if pod is in use
Mobility	Supplied with 4 heavy duty castors
Crate Size (mm)	2278W x 1138D x 668H (1.74m <sup>3</sup> )
Sustainability	UL Greenguard Certified OEKO-TEX® Standard 100
Extras	Interface Control Hub for personalised settings (light brightness, fan speed, sensor duration, occupancy light mode and intermittent air circulation duration)

LODGE FOCUS

Dimensions (mm)	1400W x 1250D x 2280H (external) 1230W x 1160D x 2030H (internal)
Weight (kg)	Net weight: 364 Packing weight: 574
Acoustic Properties	High acoustic rating (28.9 dB noise reduction) ISO 23351-1 Speech Level Reduction DS,A
Material	1.2mm electro galvanized steel
External Finishing	Epoxy powder coating (Space Grey or Smoke White colour options)
Internal Finishing	Polyester fibre acoustic felt sheet in dark grey Fibre nylon carpet in black
Glass Door	Black aluminium door frame with 8mm laminated tempered glass and door closer
Rear Glass	8mm laminated glass
Table (mm)	Melamine laminated wood desktop with black edging, sliding table (1140W x 400D x 25H)
Power	1 x UK power socket 65W USB A+C charger 1 x CAT 6 LAN outlet Power consumption 0.18A
Ventilation	1 x HEPA filtered air ventilation (99 air changes per hour) 2 x ventilation fans
Motion Sensor	Motion sensor control, 12V DC - sensor duration adjustable
Lighting	4000k LED light system with dimmable control (2 x 11W) External occupancy light (green/red) to indicate if pod is in use
Mobility	Supplied with 4 heavy duty castors 4 x adjustable foot caps
Crate Size (mm)	2238W x 998D x 1396H (3.49m <sup>3</sup> )
Sustainability	UL Greenguard Certified OEKO-TEX® Standard 100
Extras	Interface Control Hub for personalised settings (light brightness, fan speed, sensor duration, occupancy light mode and intermittent air circulation duration)

LODGE CONNECT

Dimensions (mm)	2200W x 1250D x 2280H (external) 2030W x 1160D x 2030H (internal)
Weight (kg)	Net weight: 498 Packing weight: 673
Acoustic Properties	High acoustic rating (28.9 dB noise reduction) ISO 23351-1 Speech Level Reduction DS,A
Material	1.2mm electro galvanized steel
External Finishing	Epoxy powder coating (Space Grey or Smoke White colour options)
Internal Finishing	Polyester fibre acoustic felt sheet in dark grey Fibre nylon carpet in black
Glass Door	Black aluminium door frame with 8mm laminated tempered glass and door closer
Rear Glass	8mm laminated glass
Table (mm)	Melamine laminated wood desktop with chamfered edging (700W x 550D x 25H)
Power	1 x UK power socket 65W USB A+C charger 1 x CAT 6 LAN outlet Power consumption 0.33A
Ventilation	2 x HEPA filtered air ventilation (99 air changes per hour) 4 x ventilation fans
Motion Sensor	Motion sensor control, 12V DC - sensor duration adjustable
Lighting	4000k LED light system with dimmable control (2 x 11W) External occupancy light (green/red) to indicate if pod is in use
Mobility	Supplied with 4 heavy duty castors 6 x adjustable foot caps
Crate Size (mm)	2238W x 998D x 1396H (3.49m³)
Sustainability	UL Greenguard Certified OEKO-TEX® Standard 100
Extras	Interface Control Hub for personalised settings (light brightness, fan speed, sensor duration, occupancy light mode and intermittent air circulation duration)

LODGE RETREAT

Dimensions (mm)	2400W x 2400D x 2280H (external) 2230W x 2310D x 2030H (internal)
Weight (kg)	Net weight: 833 Packing weight: 566(A) + 543(B)
Acoustic Properties	High acoustic rating (28.9 dB noise reduction) ISO 23351-1 Speech Level Reduction DS,A
Material	1.2mm electro galvanized steel
External Finishing	Epoxy powder coating (Space Grey or Smoke White colour options)
Internal Finishing	Polyester fibre acoustic felt sheet in dark grey Fibre nylon carpet in black
Glass Door	Black aluminium door frame with 8mm laminated tempered glass and door closer
Rear Glass	8mm laminated glass
Table (mm)	Melamine laminated wood desktop with black edging, sliding table (1140W x 400D x 25H)
Power	1 x UK power socket 65W USB A+C charger 1 x CAT 6 LAN outlet Power consumption 0.47A
Ventilation	6 x HEPA filtered air ventilation (99 air changes per hour) 12 x ventilation fans
Motion Sensor	Motion sensor control, 12V DC - sensor duration adjustable
Lighting	4000k LED light system with dimmable control (2 x 11W) External occupancy light (green/red) to indicate if pod is in use
Mobility	18 x adjustable foot caps
Crate Size (mm)	2378W x 1084D x 1274H (3.24m³)(A) 2378W x 1084D x 1274H (3.24m³)(B)
Sustainability	UL Greenguard Certified OEKO-TEX® Standard 100
Extras	Interface Control Hub for personalised settings (light brightness, fan speed, sensor duration, occupancy light mode and intermittent air circulation duration)



# SUSTAINABILITY INFORMATION

## POWERED BY SOLAR

Our factory roof is fitted with solar panels, supplying over 50% of our power needs. Given the energy-intensive nature of furniture manufacturing, these panels are crucial to Hawk's net zero carbon initiative. Since October 2022 our solar system has logged a reduction in CO2 of 285t, an equivalent of planting 158 trees and a saving of 114t of standard coal.

## BIOMASS BURNER

In addition to sourcing sustainable and certified board, we take extra measures to reduce our carbon footprint. Waste board is utilised to power our cutting-edge biomass burner, while larger off-cuts are repurposed for the core of our budget-friendly screens. This not only helps in offering competitively-priced desk screens but also contributes to warming our factory and powder-coating ovens, significantly cutting down on energy consumption.

## SCOPE 1, 2 & 3 EMISSIONS

Scope 2 emissions of as little as 3.1kg per product manufactured\*. Figures calculated based on 2021 usage and do not include reduction of energy that the solar panels provide (only installed in 2022).

## RESPONSIBLE MANUFACTURING

We endeavour to only source products from FSC® certified suppliers. FSC® certified timber products are available on request. (License Holder FSC®C199861).

## OUR FLEET

Our company owned vehicles are all hybrid or electric.

### NOTES ON EMISSIONS

Scope 3 is estimated and not feasible to include as Hawk has very little control over the products once they are sold into the trade (emissions of the distributor, how far they travel to deliver and what happens at the product end of life)

*\*Taken as an average over all products sold in 2021 emissions are calculated from Normative Carbon Accounting Engine and include all available data. Where no such data exists, a calculated estimate has been substituted.*

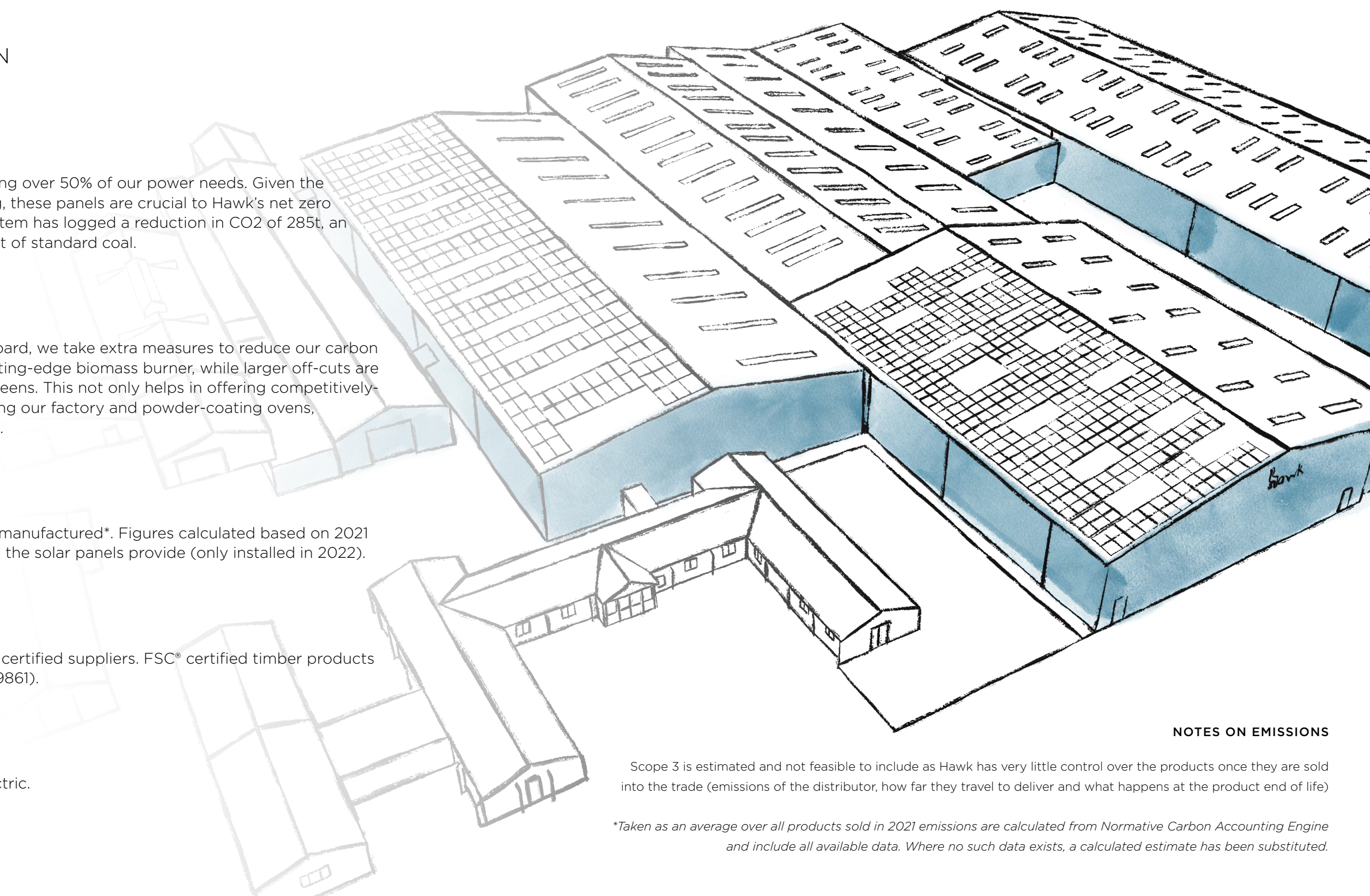

MATERIALS OVERVIEW

MFC RECYCLABLE CONTENT

The bioeconomy, a prominent resource-saving approach, states: It is better to use raw materials that regrow within a time frame of a generation than raw materials that take millions of years to regenerate.

Melamine Faced Chipboard used in the manufacture of office furniture at Hawk has been sourced from FSC® & PEFC certified suppliers. An assurance that the product that you are buying is from a sustainably managed forest.

The MFC boards that we source are made from approximately **88%** wood and paper with the exception of White, which is virgin wood and offset with the planting of trees by the supplier.

STEEL RECYCLABLE CONTENT

The production of tube comes from purchases of raw material from steel mills, that employ two different production processes:

- BOF technology (steel from oxygen furnaces), with a scrap content of 15-25%
- EAF technology (stell from electric furnaces), with a scrap content of 80-90%

The type of supplied product shall be (unless different requirements are stated at the point of order) one of these two manufacturing processes, according to availability.

CLEANING & CARE INSTRUCTIONS

CLEANING & CARE INSTRUCTIONS

MFC is the most practical and low maintenance material for use in an office environment, offering the following benefits:

- Scratch resistant
- Resistant to household cleaning products and chemicals
- Resistant to cigarette burns
- Colour-fastness under artificial light
- Resistant to cracking
- Impact resistance
- Abrasian resistant
- Ease of maintenance
- Hygenic surface

LIGHT SOILING

Clean with a paper towel, a soft clean cloth (dry/damp) or a sponge. If using a damp cloth, dry the surface with an absorbent paper towel or microfibre cloth.

NORMAL SOILING / EXTENDED CONTACT

Clean with a paper towel, a soft clean cloth (dry/damp) or a sponge. If using a damp cloth, dry the surface with an absorbent paper towel or microfibre cloth. Clean with warm water, a clean rag or microfibre cloth, a soft sponge or soft brush. Use normal domestic cleaners or soaps that have no abrasive ingredients. Then wipe with fresh water, removing all traces of the cleaning agent, to prevent streaks forming. Dry the surface with a clean, absorbent cloth or paper towels.

The following cleaning agents should not be used under any circumstances:

- Scouring and abrasive agents (abrasive powders, scouring pads, steel wool)
- Polish, washing powder, furniture cleaner, bleach
- Detergents with strong acids and acidic salts
- Steam cleaning equipment

METALWORK

Metalwork is polyester-resin powder-coated and resistant to minor scratching, chipping, abrasions, cracking and daily wear and tear and therefore only requires regular dusting and occasionally washing down with luke-warm soapy water if required. No strong detergents are required.





**Hawk Furniture Ltd**

Hawk Landings, Skiff Lane, Holme Upon Spalding Moor, York, YO43 4BB  
01430 861229 • [hawkfurniture.co.uk](http://hawkfurniture.co.uk) • [enquiries@hawkfurniture.co.uk](mailto:enquiries@hawkfurniture.co.uk)