

JUMP TO  
SPECS 



# CHARLOTTE

SEATING





## **CHARLOTTE SEATING**

Designed for ultimate relaxation, our Charlotte range is the perfect addition to your space. This collection comes in two sizes – Charlotte S for compact comfort and Charlotte L for a more spacious, enveloping sit.

Every model is fully upholstered, giving you a soft, comfortable finish and the opportunity to customise with colour or texture.





## CHARLOTTE SEATING

### SPECIFICATIONS

**Width:** 735/810mm  
**Depth:** 720/950mm  
**Height:** 875/1100mm  
**Seat Height:** 505/535mm

Available in two distinct styles: Charlotte S and Charlotte L with two base options  
Moulded flexible polyurethane shell and seat  
Fully upholstered seat  
Aluminium base can be powder-coated to any of our metalwork finishes

### SHAPES & STYLES



Charlotte S  
Aluminium Spoke



Charlotte S  
Wooden



Charlotte L  
Aluminium Spoke



Charlotte L  
Wooden

### QUALITY

This range has been designed and manufactured to our high standards of quality and is guaranteed for 5 years.

### CONFORMITY

We endeavour to only source products from FSC® certified suppliers. FSC® certified timber products are available on request. (License Holder FSC®C199861).



The mark of  
responsible forestry  
FSC® C199861

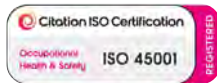
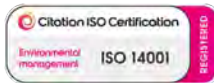



## SUSTAINABILITY INFORMATION

### POWERED BY SOLAR

Our factory roof is fitted with solar panels, supplying over 50% of our power needs. Given the energy-intensive nature of furniture manufacturing, these panels are crucial to Hawk's net zero carbon initiative. Since October 2022 our solar system has logged a reduction in CO2 of 285t, an equivalent of planting 158 trees and a saving of 114t of standard coal.

### BIOMASS BURNER

In addition to sourcing sustainable and certified board, we take extra measures to reduce our carbon footprint. Waste board is utilised to power our cutting-edge biomass burner, while larger off-cuts are repurposed for the core of our budget-friendly screens. This not only helps in offering competitively-priced desk screens but also contributes to warming our factory and powder-coating ovens, significantly cutting down on energy consumption.

### SCOPE 1, 2 & 3 EMISSIONS

Scope 2 emissions of as little as 3.1kg per product manufactured\*. Figures calculated based on 2021 usage and do not include reduction of energy that the solar panels provide (only installed in 2022).

### RESPONSIBLE MANUFACTURING

We endeavour to only source products from FSC® certified suppliers. FSC® certified timber products are available on request. (License Holder FSC®C199861).

### OUR FLEET

Our company owned vehicles are all hybrid or electric.

#### NOTES ON EMISSIONS

Scope 3 is estimated and not feasible to include as Hawk has very little control over the products once they are sold into the trade (emissions of the distributor, how far they travel to deliver and what happens at the product end of life)

*\*Taken as an average over all products sold in 2021 emissions are calculated from Normative Carbon Accounting Engine and include all available data. Where no such data exists, a calculated estimate has been substituted.*

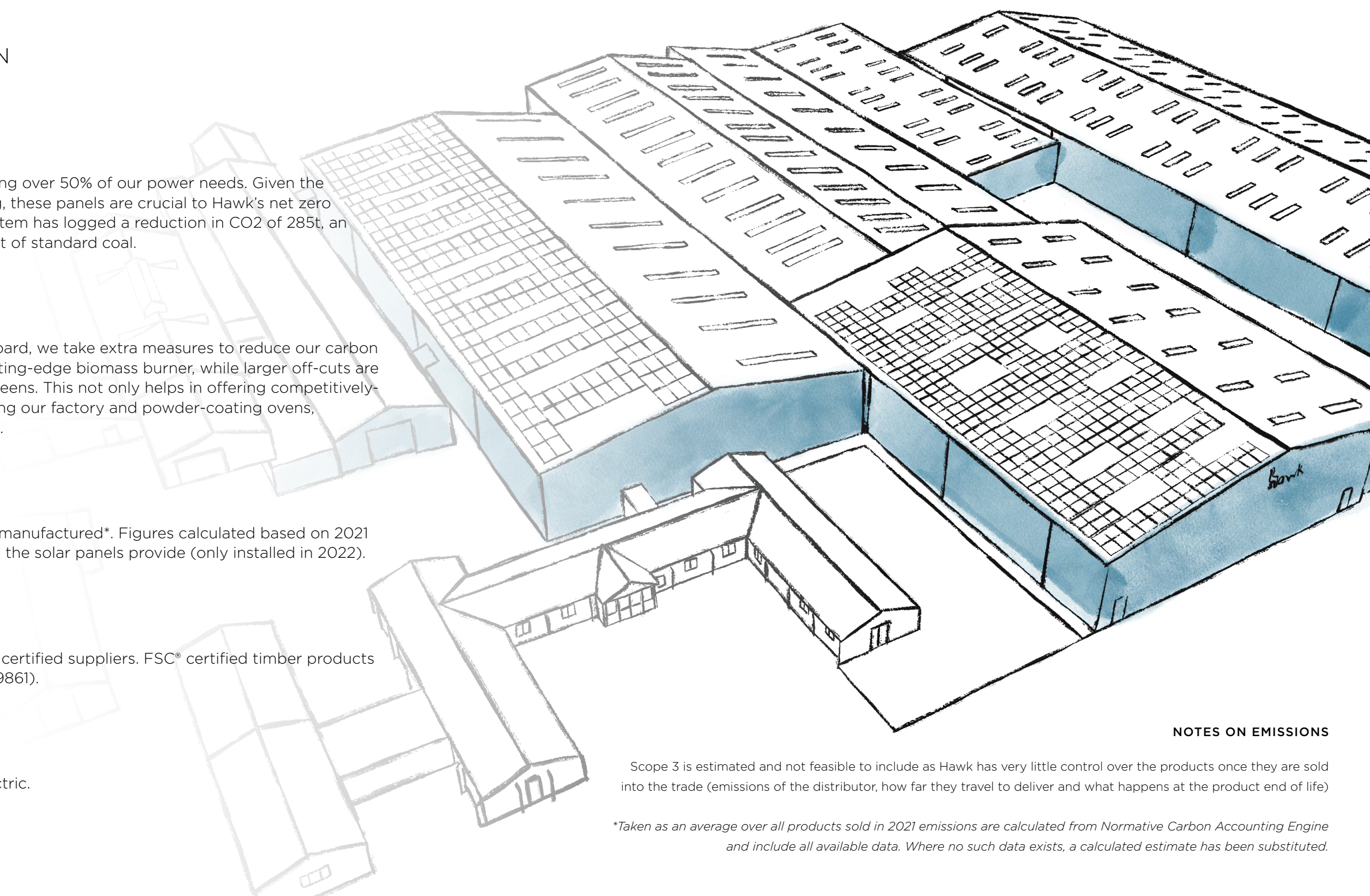

## MATERIALS OVERVIEW

### MFC RECYCLABLE CONTENT

The bioeconomy, a prominent resource-saving approach, states: It is better to use raw materials that regrow within a time frame of a generation than raw materials that take millions of years to regenerate.

Melamine Faced Chipboard used in the manufacture of office furniture at Hawk has been sourced from FSC® & PEFC certified suppliers. An assurance that the product that you are buying is from a sustainably managed forest.

The MFC boards that we source are made from approximately **88%** wood and paper with the exception of White, which is virgin wood and offset with the planting of trees by the supplier.

### STEEL RECYCLABLE CONTENT

The production of tube comes from purchases of raw material from steel mills, that employ two different production processes:

- BOF technology (steel from oxygen furnaces), with a scrap content of 15-25%
- EAF technology (stell from electric furnaces), with a scrap content of 80-90%

The type of supplied product shall be (unless different requirements are stated at the point of order) one of these two manufacturing processes, according to availability.

## CLEANING & CARE INSTRUCTIONS

### CLEANING & CARE INSTRUCTIONS

MFC is the most practical and low maintenance material for use in an office environment, offering the following benefits:

- Scratch resistant
- Resistant to household cleaning products and chemicals
- Resistant to cigarette burns
- Colour-fastness under artificial light
- Resistant to cracking
- Impact resistance
- Abrasian resistant
- Ease of maintenance
- Hygenic surface

### LIGHT SOILING

Clean with a paper towel, a soft clean cloth (dry/damp) or a sponge. If using a damp cloth, dry the surface with an absorbent paper towel or microfibre cloth.

### NORMAL SOILING / EXTENDED CONTACT

Clean with a paper towel, a soft clean cloth (dry/damp) or a sponge. If using a damp cloth, dry the surface with an absorbent paper towel or microfibre cloth. Clean with warm water, a clean rag or microfibre cloth, a soft sponge or soft brush. Use normal domestic cleaners or soaps that have no abrasive ingredients. Then wipe with fresh water, removing all traces of the cleaning agent, to prevent streaks forming. Dry the surface with a clean, absorbent cloth or paper towels.

The following cleaning agents should not be used under any circumstances:

- Scouring and abrasive agents (abrasive powders, scouring pads, steel wool)
- Polish, washing powder, furniture cleaner, bleach
- Detergents with strong acids and acidic salts
- Steam cleaning equipment

### METALWORK

Metalwork is polyester-resin powder-coated and resistant to minor scratching, chipping, abrasions, cracking and daily wear and tear and therefore only requires regular dusting and occasionally washing down with luke-warm soapy water if required. No strong detergents are required.



**Hawk Furniture Ltd**

Hawk Landings, Skiff Lane, Holme Upon Spalding Moor, York, YO43 4BB  
01430 861229 • [hawkfurniture.co.uk](http://hawkfurniture.co.uk) • [enquiries@hawkfurniture.co.uk](mailto:enquiries@hawkfurniture.co.uk)